

**Tax Map  
12  
HERMON  
MAINE**



**LEGEND**

- PROPERTY LINE
- EASEMENT
- PUBLIC RIGHT-OF-WAY
- PRIVATE RIGHT-OF-WAY
- RAILROAD RIGHT-OF-WAY
- PARCEL HOOK
- STREET NUMBER
- PARCEL NUMBER
- ACCOUNT NUMBER
- SURVEY DIMENSION (FT)
- WETLAND
- HYDROLOGY

This map is prepared for the inventory of real property within the Town of Hermon and is compiled from recorded deeds, plats, tax maps, surveys, planimetric maps, and other public records and data. Users of this tax map are hereby notified that the aforementioned public primary information sources should be consulted for verification of the information contained on this map. The Town of Hermon and its mapping contractors assume no legal responsibility for the information contained herein.

SCALE: 1 in = 200 ft

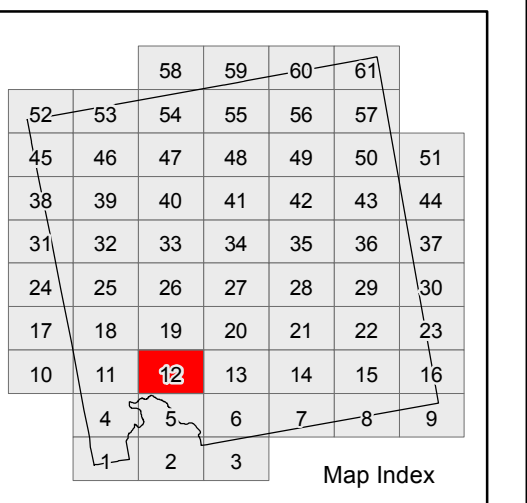

Print Date: 1/23/2018

Hermon Assessor's Office  
333 Billings Road  
Hermon, ME 04401  
(207) 848-1049

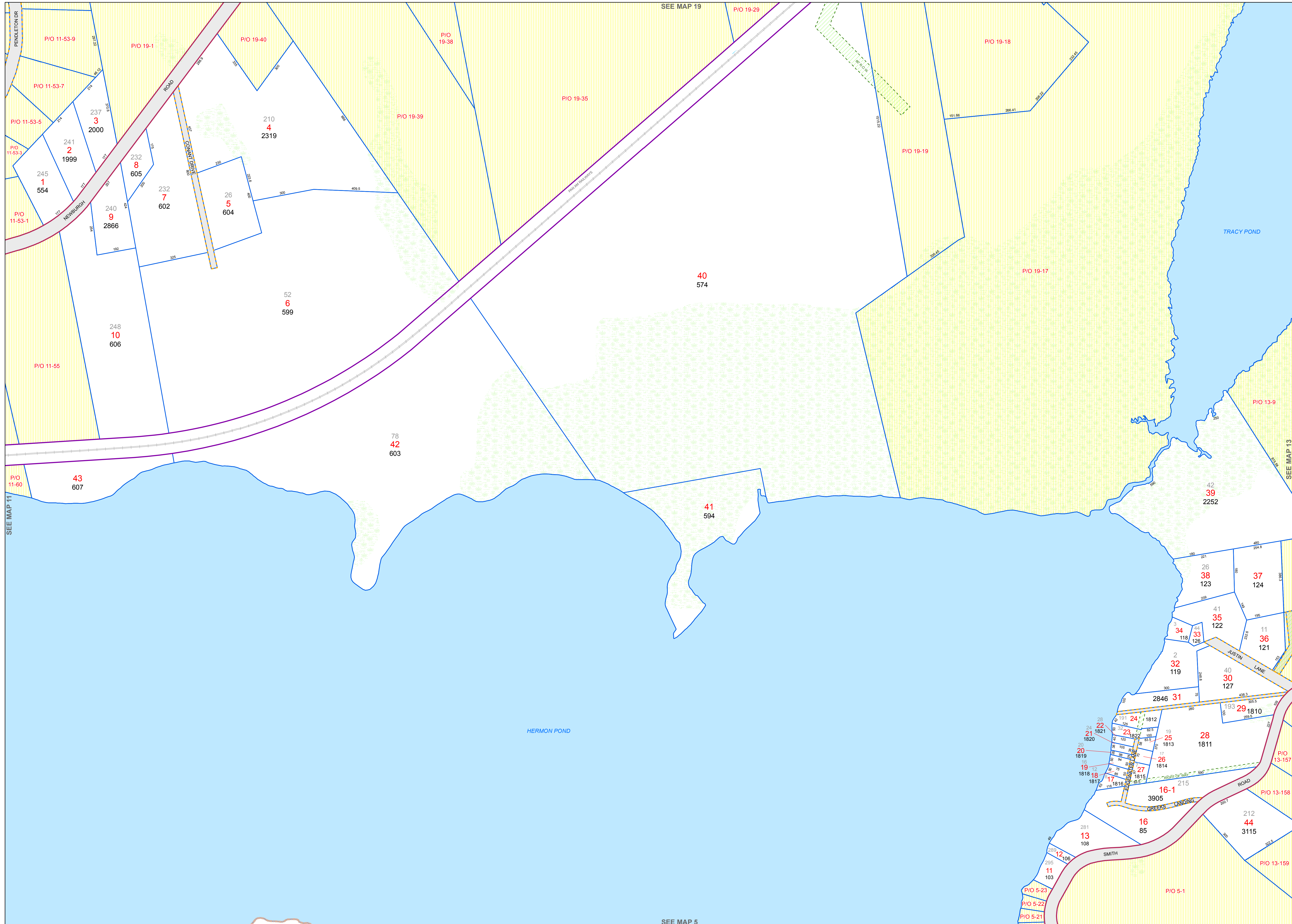

SEE MAP 5