

**Tax Map  
36  
HERMON  
MAINE**



**LEGEND**

- PROPERTY LINE
- EASEMENT
- PUBLIC RIGHT-OF-WAY
- PRIVATE RIGHT-OF-WAY
- RAILROAD RIGHT-OF-WAY
- PARCEL HOOK
- STREET NUMBER
- PARCEL NUMBER
- ACCOUNT NUMBER
- SURVEY DIMENSION (FT)
- WETLAND
- HYDROLOGY

This map is prepared for the inventory of real property within the Town of Hermon and is compiled from recorded deeds, plats, tax maps, surveys, planimetric maps, and other public records and data. Users of this tax map are hereby notified that the aforementioned public primary information sources should be consulted for verification of the information contained on this map. The Town of Hermon and its mapping contractors assume no legal responsibility for the information contained herein.

SCALE: 1 in = 200 ft



	58	59	60	61
52	53	54	55	56
45	46	47	48	49
38	39	40	41	42
31	32	33	34	35
24	25	26	27	28
17	18	19	20	21
10	11	12	13	14
4	5	6	7	8
1	2	3		

Map Index

Print Date: 3/13/2018

Hermon Assessor's Office  
333 Billings Road  
Hermon, ME 04401  
(207) 848-1049

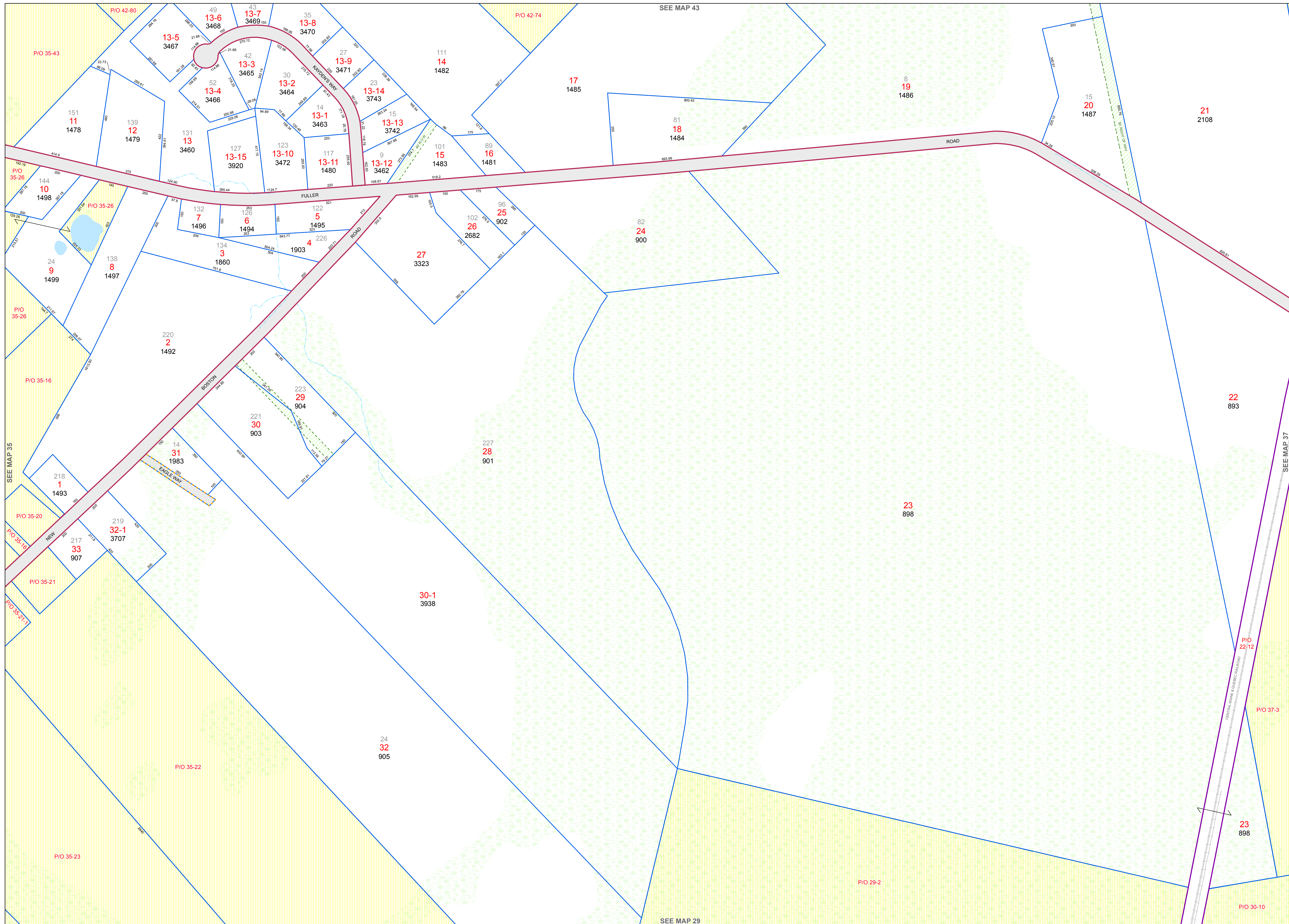

SEE MAP 43

SEE MAP 29

SEE MAP 35

SEE MAP 37